

# Model 135MR

**Current Transformer Multi-Ratio  
Window Diameter 5.75"**

## Application

Relaying.

## Frequency

50-400 Hz.

## Insulation Level

600 Volt, 10 kV BIL full wave.

Terminals are brass screws No. 10-32 with one flatwasher and lockwasher.

The transformer winding is arranged so that the turns are fully distributed between all taps.

Order mounting bracket kit 0221B00186 separately.

Approximate weight 18 lbs.



**REGULATORY AGENCY APPROVALS**  
  
 E93779 LR89403  
 Manufactured to meet the requirements of ANSI/IEEE C57.13.  
 Classified by U.L. in accordance with IEC 44-1

## Model 135MR

Catalog Number	Relay Class	Continuous Thermal Rating Factor	
		@ 30 °C	@ 55 °C
		135-601MR	C50
135-122MR	C100	1.5	1.33
135-202MR	C100	1.0	0.8
135-302MR	C200	1.0	0.8
135-402MR	C200	1.0	0.6
135-502MR	C200	1.0	0.6

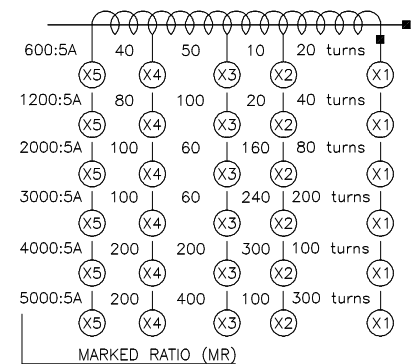
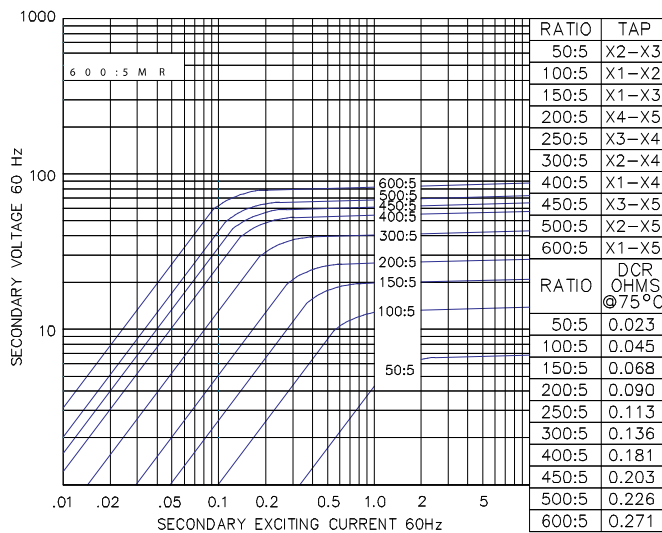

# Model 135MR

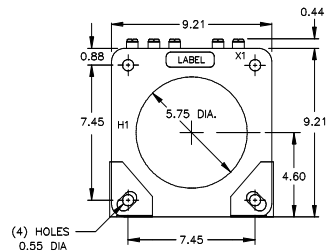
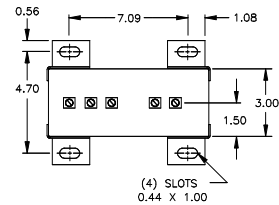
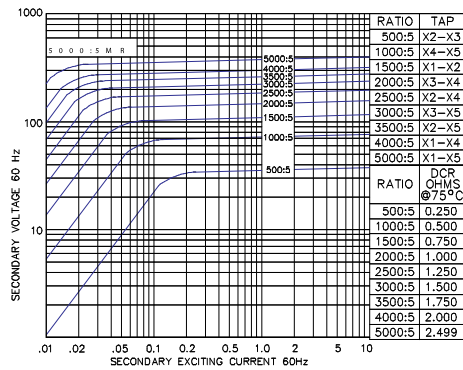
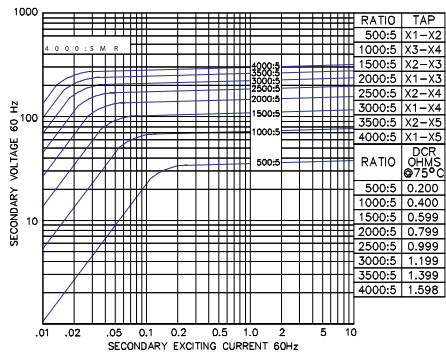
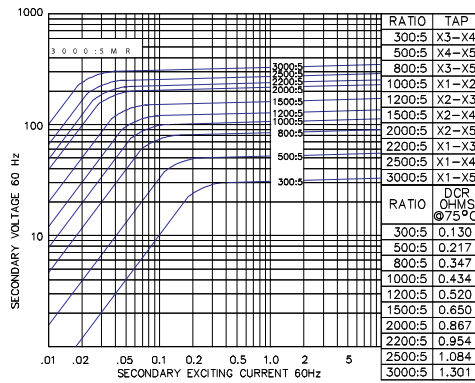
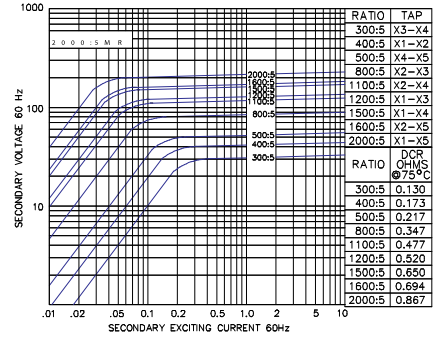
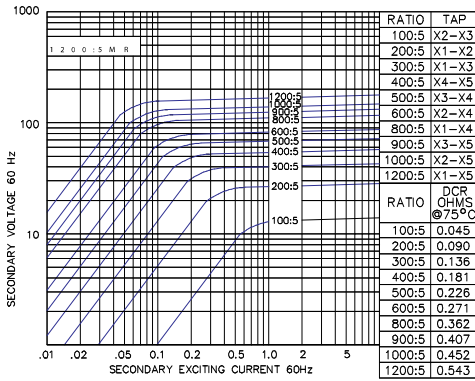

[GEGridSolutions.com](http://GEGridSolutions.com)

Grid-AIS-L4-ITL\_Model\_135MR-1245-2017\_05-EN. © Copyright 2017. General Electric Company and Instrument Transformers LLC reserve the right to change specifications of described products at any time without notice and without obligation to notify any person of such changes.

### Worldwide Contact Center

Web: [www.GEGridSolutions.com/contact](http://www.GEGridSolutions.com/contact)

Phone: +44 (0) 1785 250 070

USA and Canada: +1 (0) 800 547 8629

Europe, Middle East and Africa: +34 (0) 94 485 88 00

